

## **LAKE VERMONT EXTENSION PROJECT SUPPORTING DOCUMENT**

### **Statement – permit location: corner coordinates**

Bowen Basin Coal Pty Ltd (Bowen Basin Coal) (ACN 065 321 440) is the 100% applicant of the Lake Vermont Extension Project Mining Lease Application (MLA). Bowen Basin Coal is a private company owned by the Lake Vermont Joint Venture (LVJV), an unincorporated Australian Joint Venture (JV) operating in Queensland comprising QCMM (Lake Vermont Holdings Pty Ltd (70%), Marubeni Coal Pty Ltd (10%), CHR Vermont Pty Ltd (10%) and Coranar (Australia) Pty Ltd (10%). The LVJV participants support Bowen Basin Coal as applicant for the Lake Vermont Extension Project.

The corner coordinates for the Lake Vermont Extension Project MLA are provided below in Figure 1. Figure 1 provides the dimensions of the MLA boundary (please refer to the legend for detailed boundary dimension information). As indicated in Figure 2, all corner coordinates of the sought Lake Vermont Extension Project MLA are located on a single lot on plan: 102SP310393. Bowen Basin Coal is the registered holder of 102SP310393.

Please refer to the additional Lake Vermont Extension Project supporting documents – access details and adjoining resource authorities and land parcels – for further information to support the Lake Vermont Extension Project permit location.

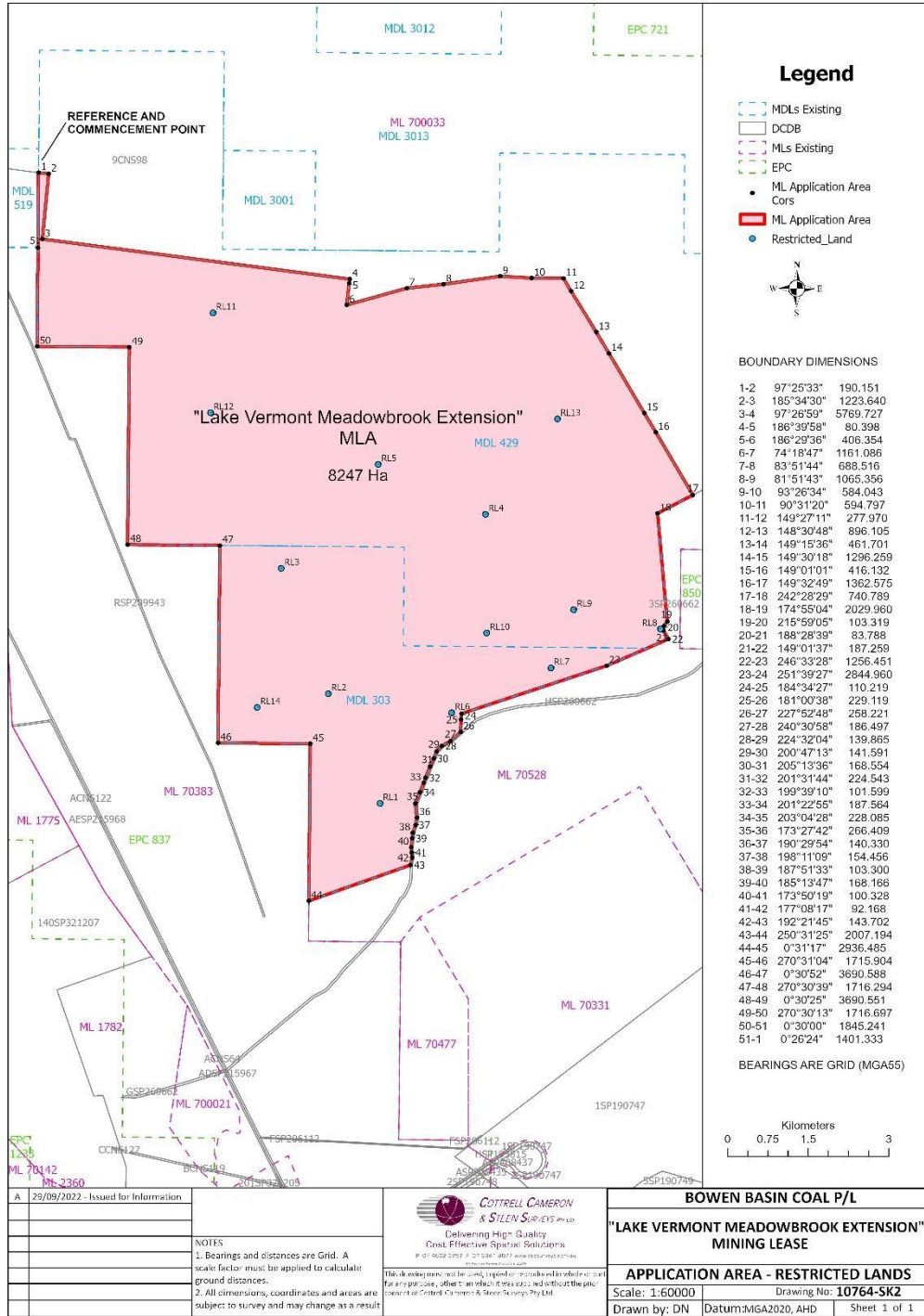

Figure 1. Lake Vermont Extension Project: Boundary corner coordinates

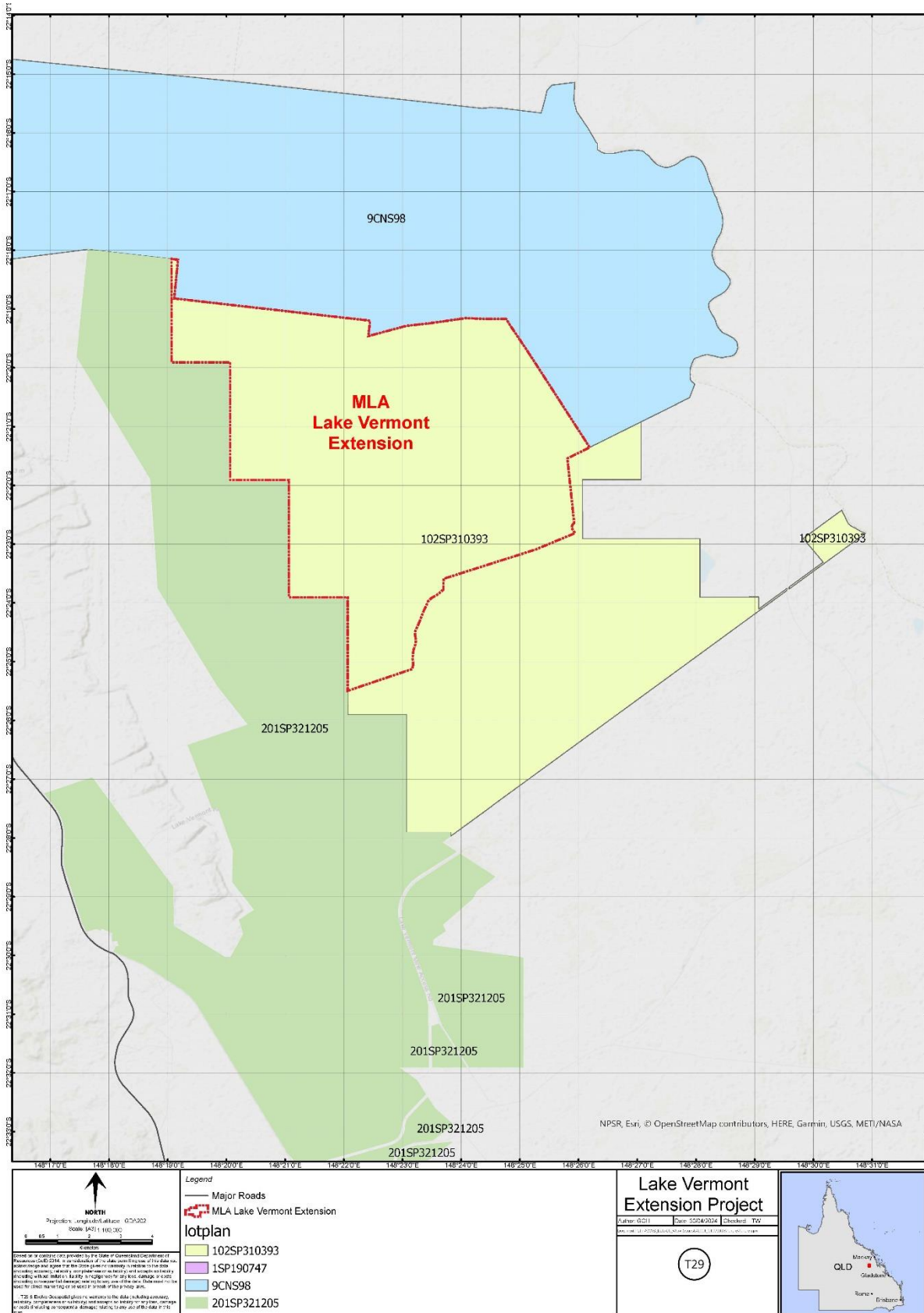

Figure 2. Lake Vermont Extension Project MLA: Lot on Plan